

USERS

The right wood fibre insulation
for roofs, façades, and interiors



Content

Applications and solutions	4
Roof	5
Façade	6
Interior	7
Product overview	8
Ecological wood fibre insulation for new builds and modernisation projects – from the roof to the basement ceiling	8
GUTEX Multiplex-top	10
GUTEX Ultratherm	10
GUTEX Thermosafe-homogen	12
GUTEX Thermoflat	13
GUTEX Thermoflex	13
GUTEX Thermofibre	14
GUTEX Multitherm	14
GUTEX Thermoinstal	15
GUTEX Thermoroom	15
GUTEX Thermosafe-wd	16
GUTEX Thermosafe-nf	16
GUTEX Thermofloor	17
GUTEX Happy Step	17
GUTEX Standard-n	17
GUTEX Thermowall	18
GUTEX Thermowall NF	19
GUTEX Thermowall-gf	20
GUTEX Thermowall-L	21
GUTEX Thermowall Durio	21

APPLICATIONS AND SOLUTIONS

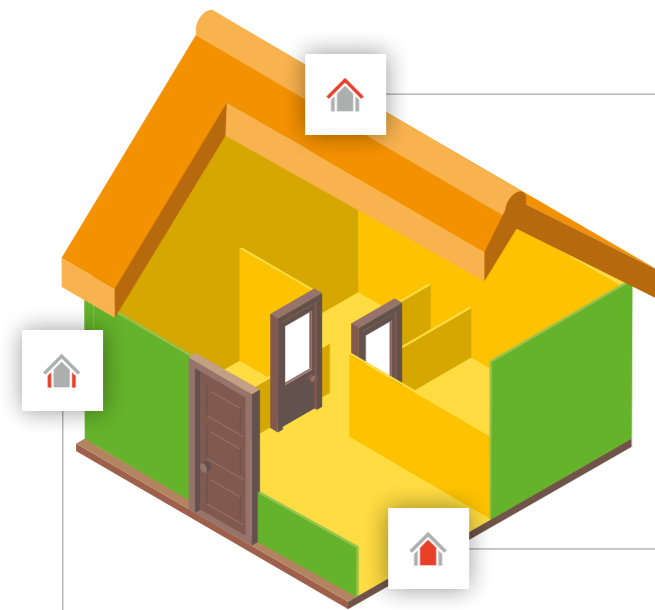

Roof

- **Tecadio roof renovation system**
- On-roof insulation
- Sarking boards
- Flat roof insulation
- Panel insulation (GUTEX Thermoflex insulation mat and GUTEX Thermofibre blow-in insulation)

Interior

- **Intevio interior insulation system**
- Sarking from inside
- Under-rafter insulation
- Insulation under screed (dry/wet)
- Suspended ceiling
- Solid wood floor/wooden floor
- Insulation of installation level
- Partition walls
- Panel insulation (GUTEX Thermoflex insulation mat and GUTEX Thermofibre blow-in insulation)

Façade

- **Thermowall ETICS thermal insulation system**
- Render
- Rainscreen façade
- Clinker facing shell
- **Durio façade insulation system**
- **Implio window and door integration system**
- Panel insulation (GUTEX Thermoflex insulation mat and GUTEX Thermofibre blow-in insulation)



Roof

Heat protection, sound insulation, ideal rain protection

With roof insulation materials from GUTEX, buildings can withstand any stresses and strains: Our sarking boards are not only rainproof, they are also hailproof – as confirmed by TÜV Rheinland. Our insulation materials also reliably protect against cold and offer excellent heat protection – thanks to low thermal conductivity and a very high heat storage capacity. Great vapour permeability and strong moisture storage and release capacity ensure structural safety. High compressive and flexural strength make the boards resistant to impact loads and enable robust handling by tradepeople. This robustness means faster handling, as does the high dimensional accuracy. Nail seals or sealing tapes are not required to produce the makeshift coverings. These makeshift coverings can be exposed to the elements for twelve weeks.

Benefits

- Sarking boards with patented tongue and groove profiling: guaranteed rainproof and robust
- TÜV-tested hail protection (hail protection class HW5)
- High resistance to ageing
- Cross-brand cooperation with system partners, e.g. manufacturers of air sealing membranes and adhesive technology
- Seminars for systematic knowledge transfer



Façade

Energy efficiency, comfort, healthy living

With GUTEX systems and products for insulating façades, you can build to efficiency house standards and at the same time ensure a comfortable and healthy home. GUTEX Thermowall is the ETICS for timber and solid construction. The Durio façade insulation system offers you maximum freedom in exterior wall design. Implio supports the creation of optimal connections in the ETICS. In the rainscreen façade, you can use our wood fibre insulation boards universally: on masonry, solid wood, and wooden post-and-beam structures.

Benefits

- Thermowall ETICS with supplementary general building authority approval: render can be purchased from 16 manufacturers
- ETICS to be mounted directly on the wooden studs
- Vapour-permeable external insulation for maximum façade safety
- Cross-brand cooperation with system partners, e.g. render manufacturers
- High transparency and safety in planning and handling thanks to 340 timber wall constructions confirmed by fire experts

Interior

Improved thermal insulation, good sound insulation, great living comfort

The Intevio interior insulation system is easy and quick to apply and reliably protects against mould. Thanks to low costs and high energy cost savings, modernisation projects pay off quickly. GUTEX floor insulation boards are suitable for both concrete and wood joist ceilings – good sound insulation and a wide range of installation options are included, also in combination with our panel insulation materials. Under wet screed, mastic asphalt, chipboard, and OSB boards, dry screed, prefabricated parquet, laminate, hardwood floors, and floorboards, for example. Special solutions are also available for the construction of installation levels and lightweight partitions.

Benefits

- Moisture-tolerant interior insulation system
- Insulation boards with top impact and airborne sound insulation properties
- Numerous tested and evaluated sound insulation structures
- Floor insulation boards with high compressive strength and good thermal conductivity

PRODUCT OVERVIEW

Ecological wood fibre insulation for new builds and modernisation projects – from the roof to the basement ceiling

GUTEX has the right wood fibre insulation solution for every need: as a thermal insulation system, as wall insulation for rainscreen façades, on-roof or panel insulation with rainproof sarking boards, insulation for floor ceilings, interior insulation for exterior walls, insulation for installation levels, impact sound insulation for floors, and as a sound-absorbing base for hardwood and laminate flooring. Our products are made of Black Forest fir and spruce from sustainable forestry and meet the highest quality standards. The KEYMARK certification mark confirms that they comply with all relevant EU standards.



GUTEX Multiplex-top
Certified rainproof sarking board



GUTEX Ultratherm
Unique rainproof sarking board thanks to patented tongue and groove profiling – with a high insulation value



GUTEX Multitherm
Moisture-resistant wood fibre insulation board for rainscreen façades, as additional above-rafter insulation, or as under-rafter insulation



GUTEX Thermosafe-homogen
Universal wood fibre insulation board with excellent insulation properties for roofs and exterior walls.



GUTEX Thermofibre
Wood fibre blow-in insulation for panels and as exposed insulation on horizontal surfaces



GUTEX Thermoflex
Flexible wood fibre insulation mat for between-rafter and panel insulation



GUTEX Thermoflat
Pressure-resistant wood fibre insulation board for flat roofs made of wood, concrete, or sheet metal



GUTEX Thermoinstal
Pressure-resistant wood fibre insulation board for installation levels



GUTEX Thermoroom
Wood fibre insulation board for interior insulation of exterior walls



GUTEX Thermosafe-wd
Pressure-resistant wood fibre insulation board for interior floor and wall structures



GUTEX Thermosafe-nf
Impact sound insulation board with a spruce installation strip – ideal as a substructure for screwed floorboards or hardwood floors



GUTEX Thermofloor
Impact sound insulation board for all floor structures

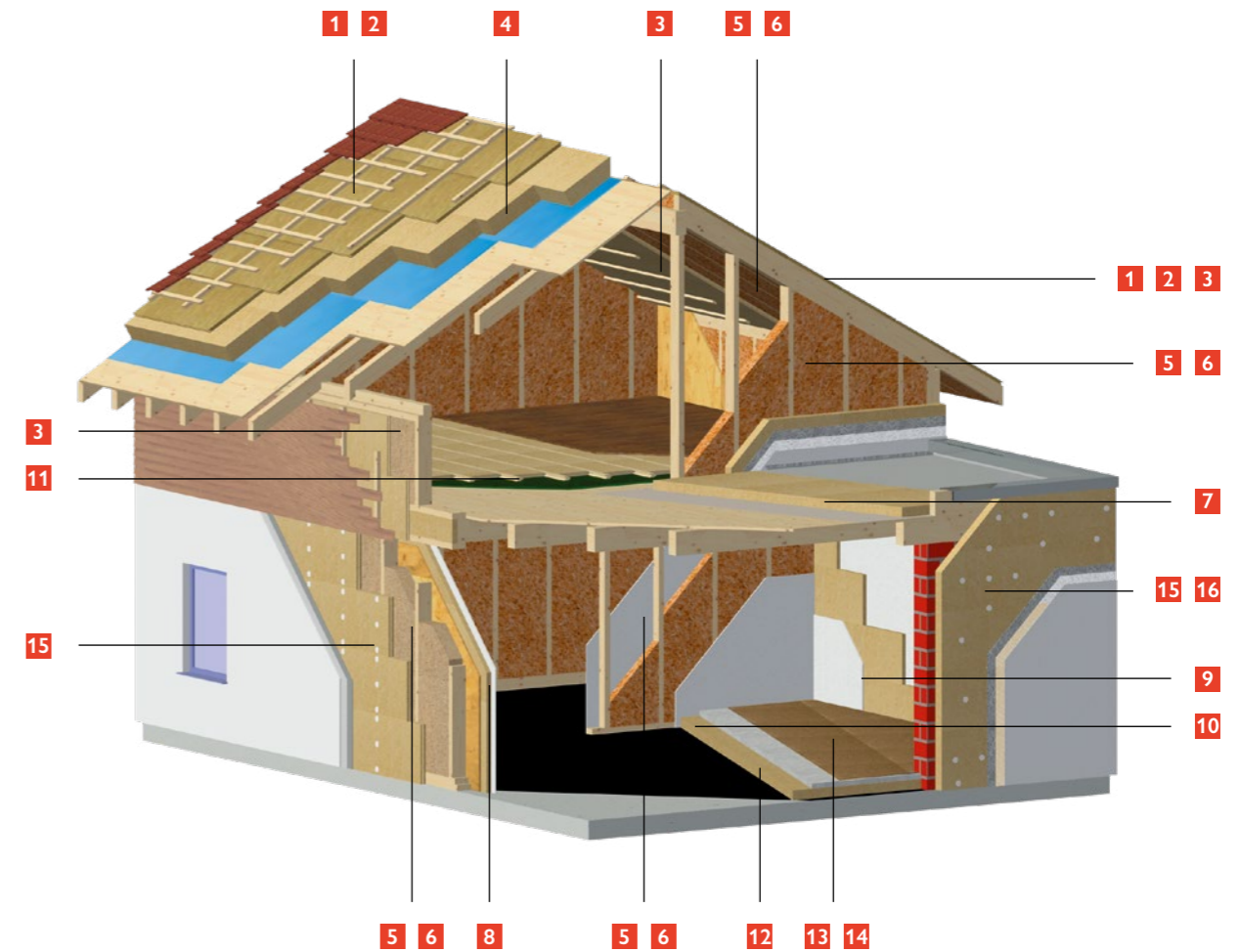

GUTEX Happy Step
Base board for increased walking comfort and impact sound insulation, e.g. with hardwood floors



GUTEX Standard-n
Underlay manufactured using a wet process, comes in various thicknesses and is ideal for smoothing out uneven floors, etc.



GUTEX Thermowall-gf/NF
Plaster baseboard for the ecological Thermowall ETICS



GUTEX Thermowall-L
Light plaster baseboard with excellent insulation performance for the ecological Thermowall ETICS – ideal for full-surface mineral or solid wood substrates



GUTEX Thermowall Durio
Special board in the Durio façade insulation system for rendered and rainscreen wood façades.

More information on correct handling and usage of our insulation materials available at www.gutex.de

Product name	GUTEX Multiplex-top			GUTEX Ultratherm						
Bulk density ρ [kg/m ³]	~ 220			~ 180						
Nominal thermal conductivity λ_D [W/mK]	0.045			0.042						
Vapour diffusion μ	3			3						
Compressive stress/strength [kPa]	≥ 200			≥ 150						
Tensile strength perpendicular to the surface [kPa]	≥ 30			≥ 20						
Short-term water absorption [kg/m ²]	≤ 1			≤ 1						
Air flow resistivity [kPa s/m ²]	≥ 100			≥ 100						
Specific heat capacity [J/kgK]	2100			2100						
Maximum working temperature [°C]	110			110						
Fire reaction Euro Class as per EN 13501-1	E			E						
Joint type	Tongue and groove			Tongue and groove						
Thickness [mm]	22	28*	35	50*	60	80	100	120	140	160
Length × width [mm × mm]	2500 × 750			1780 × 600						
Actual coverage: Length × width [mm × mm]	2480 × 728		2480 × 722	1749 × 569						
Actual coverage: Square metres per board [m ²]	1.81		1.79	1.00						
m ² /Piece(s)	1.87			1.06						
Weight per board [kg]	9.07	11.55	14.44	9.60	11.50	15.40	19.20	23.10	26.90	30.80
Weight per m ² [kg]	4.84	6.16	7.70	9.00	10.80	14.40	18.00	21.60	25.20	28.80
Piece(s)/Pallet	45	35	30	42	36	26	20	18	14	12
Square metres per pallet [m ²]	84.37	65.62	56.25	44.85	38.44	27.76	21.36	19.22	14.95	12.81
Weight per pallet [kg]	520	430	485	490		430	390	420	390	
Nominal thermal resistance R_D [m ² K/W]	0.50	0.60	0.75	1.15	1.40	1.90	2.35	2.85	3.30	3.80
sd value [m]	0.07	0.08	0.11	0.15	0.18	0.24	0.30	0.36	0.42	0.48

* Article currently not available

Product name	GUTEX Thermosafe-homogen												GUTEX Thermoflat				GUTEX Thermoflex															
Bulk density ρ [kg/m ³]	~ 110												~ 140				~ 50															
Nominal thermal conductivity λ_D [W/mK]	0.039												0.040				0.036															
Vapour diffusion μ	4												3				2															
Compressive stress/strength [kPa]	≥ 50												≥ 70																			
Tensile strength perpendicular to the surface [kPa]	≥ 5												≥ 7.5				≥ 1															
Short-term water absorption [kg/m ²]	≤ 2												≤ 1																			
Air flow resistivity [kPa s/m ²]	≥ 60												≥ 100				≥ 5															
Specific heat capacity [J/kgK]	2100												2100				2100															
Maximum working temperature [°C]	110												110				110															
Fire reaction Euro Class as per EN 13501-1	E												E				E															
Joint type	Flush-mount						Rebate joint						Rebate joint				Flush-mount															
Thickness [mm]	40	60	80	100	120	140	160	180	200	220	240	100	120	140	160	30	40	50	60	80	100	120	140	160	180	200	220	240				
Length \times width [mm \times mm]	1200 \times 625												1230 \times 600				1350 \times 575															
Actual coverage: Length \times width [mm \times mm]													1185 \times 610				1215 \times 585															
Actual coverage: Square metres per board [m ²]													0.72				0.71															
m ² /Piece(s)	0.75												0.73				0.77															
Weight per board [kg]	3.30	5.00	6.60	8.30	9.90	11.60	13.20	14.90	16.50	18.20	19.80	10.30	12.40	14.50	16.50	1.20	1.60	1.90	2.30	3.10	3.90	4.70	5.40	6.20	7.00	7.80	8.50	9.30				
Weight per m ² [kg]	4.40	6.60	8.80	11.00	13.20	15.40	17.60	19.80	22.00	24.20	26.40	14.00	16.80	19.60	22.40	1.50	2.00	2.50	3.00	4.00	5.00	6.00	7.00	8.00	9.00	10.00	11.00	12.00				
Piece(s)/Package																	12	8	9	8	6	4			3			2				
Packs per pallet																	12	14	10			12	10	8	10	8	12	10				
Piece(s)/Pallet	112	70	56	42	36	32	28	24	22	20	18	44	36	32	28	144	112	90	80	60	48	40	32	30	24			20				
Square metres per pallet [m ²]	84.00	52.50	42.00	31.50	27.00	24.00	21.00	18.00	16.50	15.00	13.50	32.47	26.56	23.61	20.66	111.78	86.94	69.86	62.10	46.57	37.26	31.05	24.84	23.28	18.63			15.52				
Weight per pallet [kg]	430	380	390	340	380	420			410			490				200																
Nominal thermal resistance R_D [m ² K/W]	1.00	1.50	2.05	2.55	3.05	3.55	4.10	4.60	5.10	5.60	6.15	2.50	3.00	3.50	4.00	0.80	1.10	1.35	1.65	2.20	2.75	3.30	3.85	4.40	5.00	5.55	6.10	6.65				
sd value [m]	0.16	0.24	0.32	0.40	0.48	0.56	0.64	0.72	0.80	0.88	0.96	0.30	0.36	0.42	0.48	0.06	0.08	0.10	0.12	0.16	0.20	0.24	0.28	0.32	0.36	0.40	0.44	0.48				

Product name	GUTEX Thermofibre		GUTEX Multitherm									GUTEX Thermoinstal	GUTEX Thermoroom							
Bulk density ρ [kg/m ³]			~ 140									~ 150	~ 150	~ 130						
Blow-in bulk density ρ exposed [kg/m ³]	25 – 30																			
Blow-in bulk density ρ enclosed [kg/m ³]	29 – 50																			
Nominal thermal conductivity λ_D [W/mK]	0.038		0.040									0.040	0.040	0.039						
Vapour diffusion μ	2		4									3		3						
Compressive stress/strength [kPa]			≥ 70									≥ 100		≥ 50						
Tensile strength perpendicular to the surface [kPa]			≥ 7.5									≥ 10		≥ 7.5						
Short-term water absorption [kg/m ²]			≤ 1																	
Air flow resistivity [kPa s/m ²]	≥ 3		≥ 60									≥ 100		≥ 100						
Specific heat capacity [J/kgK]	2100		2100									2100		2100						
Maximum working temperature [°C]			110									110								
Fire reaction Euro Class as per EN 13501-1	E		E									E		E						
Joint type			Tongue and groove									Flush-mount	Flush-mount	Flush-mount						
Version	Packed	Unpacked																		
Thickness [mm]	330		40	60	80	100	120	140	160	180	200	60	50	20	40	50	60	80	100	
Length x width [mm x mm]	400 x 800		1760 x 600									3000 x 1250	1250 x 600	1200 x 500						
Actual coverage: Length x width [mm x mm]			1740 x 580																	
Actual coverage: Square metres per board [m ²]			1.01																	
kg/Bale	15.00		1.05									3.75	0.75	0.60	0.60					
Weight per board [kg]			5.90	8.90	11.80	14.80	17.70	20.70	23.70	26.60	29.60	31.50	5.60	1.80	3.10	3.90	4.70	6.20	7.80	
Weight per m ² [kg]			5.60	8.40	11.20	14.00	16.80	19.60	22.40	25.20	28.00	8.40	7.50	3.00	5.20	6.50	7.80	10.40	13.00	
Bale/Pallet	21	18	54	36	26	22	18	16	14	12	10	15	84	96	48	36	30	24	18	
Square metres per pallet [m ²]			57.02	38.01	27.45	23.23	19.00	16.89	14.78	12.67	10.56	56.25	63.00	57.60	28.80	21.60	18.00	14.40	10.80	
Weight per pallet [kg]	330	290	350		330	350					320	520	520	200	180	170		180	170	
Nominal thermal resistance R_D [m ² K/W]			1.00	1.50	2.00	2.50	3.00	3.50	4.00	4.50	5.00	1.50	1.25	0.50	1.00	1.25	1.50	2.05	2.55	
sd value [m]			0.16	0.24	0.32	0.40	0.48	0.56	0.64	0.72	0.80	0.24	0.15	0.06	0.12	0.15	0.18	0.24	0.30	

Product name	GUTEX Thermosafe-wd						GUTEX Thermosafe-nf	GUTEX Thermofloor		GUTEX Happy Step	GUTEX Standard-n				
Bulk density ρ [kg/m ³]	~ 140						~ 130	~ 160		~ 260	~ 250				
Nominal thermal conductivity λ_D [W/mK]	0.040						0.039	0.040		0.046	0.046				
Vapour diffusion μ	3						3	5		5	5				
Compressive stress/strength [kPa]	≥ 70									≥ 100	≥ 100				
Short-term water absorption [kg/m ²]										≤ 2	≤ 2				
Dynamic stiffness [MN/m ³]							≤ 50	≤ 30							
Compressibility with live loads ≤ 5 kPa [mm]	2						2	2							
Air flow resistivity [kPa s/m ²]	≥ 100						≥ 100	≥ 100		≥ 100	≥ 100				
Specific heat capacity [J/kgK]	2100						2100	2100		2100	2100				
Maximum working temperature [°C]	110						110	110		110	110				
Fire reaction Euro Class as per EN 13501-1	E						E	E		E	E				
Joint type	Flush-mount						Tongue and groove	Flush-mount		Flush-mount	Flush-mount				
Thickness [mm]	30	40	60	80	100	120	40	20	30	6	8	10	12	15	18
Length \times width [mm \times mm]	1250 \times 600						1190 \times 380	1200 \times 600		860 \times 590	2500 \times 1000				
Actual coverage: Length \times width [mm \times mm]							1170 \times 360								
Actual coverage: Square metres per board [m ²]							0.42								
m ² /Piece(s)	0.75						0.45	0.72		0.50	2.50				
Weight per board [kg]	3.20	4.20	6.30	8.40	10.50	12.60	2.35	2.30	3.50	0.80	5.00	6.30	7.50	9.40	11.30
Weight per m ² [kg]	4.20	5.60	8.40	11.20	14.00	16.80	5.20	3.20	4.80	1.60	2.00	2.50	3.00	3.80	4.50
Piece(s)/Package										20					
Packs per pallet										32					
Piece(s)/Pallet	140	112	70	56	42	36	75	180	120	640	130	100	80	70	55
Square metres per pallet [m ²]	105.00	84.00	52.50	42.00	31.50	27.00	33.91	129.60	86.40	324.73	325.00	250.00	200.00	175.00	137.50
Weight per pallet [kg]	520	510	460	490	470		200	450		540	700				
Nominal thermal resistance R_D [m ² K/W]	0.75	1.00	1.50	2.00	2.50	3.00	1.00	0.50	0.75	0.10	0.15	0.20	0.25	0.30	0.35
sd value [m]	0.09	0.12	0.18	0.24	0.30	0.36	0.12	0.10	0.15	0.03	0.04	0.05	0.06	0.08	0.09

Product name	GUTEX Thermowall																			GUTEX Thermowall NF
Bulk density ρ [kg/m ³]	~ 160																			~ 160
Nominal thermal conductivity λ_D [W/mK]	0.040																			0.040
Vapour diffusion μ	4																			4
Compressive stress/strength [kPa]	≥ 100																			≥ 100
Tensile strength perpendicular to the surface [kPa]	≥ 10																			≥ 10
Short-term water absorption [kg/m ²]	≤ 1																			≤ 1
Air flow resistivity [kPa s/m ²]	≥ 100																			≥ 100
Specific heat capacity [J/kgK]	2100																			2100
Maximum working temperature [°C]	110																			110
Fire reaction Euro Class as per EN 13501-1	E																			E
Joint type	Flush-mount												Tongue and groove					Tongue and groove		
Thickness [mm]	20	40	60	80	100	140	120	160	80	100	120	80	100	120	80	100	120	140	160	60
Length x width [mm x mm]	1250 x 590				830 x 600				2600 x 1250			2800 x 1250			1300 x 600					1800 x 600
Actual coverage: Length x width [mm x mm]													1275 x 575			1280 x 580			1780 x 580	
Actual coverage: Square metres per board [m ²]													0.73			0.74			1.03	
m ² /Piece(s)	0.73				0.49				3.25			3.50			0.78					1.08
Weight per board [kg]	2.40	4.70	7.10	9.40	8.00	11.20	9.60	12.70	41.60	52.00	62.40	44.80	56.00	67.20	10.00	12.50	15.00	17.50	20.00	10.40
Weight per m ² [kg]	3.20	6.40	9.60	12.80	16.00	22.40	19.20	25.60	12.80	16.00	19.20	12.80	16.00	19.20	12.80	16.00	19.20	22.40	25.60	9.60
Piece(s)/Pallet	224	112	70	56	40	28	32	24	12	9	8	12	9	8	56	44	36	32	28	36
Square metres per pallet [m ²]	165.20	82.60	51.62	41.30	19.92	13.94	15.93	11.95	39.00	29.25	26.00	42.00	31.50	28.00	43.68	34.32	28.08	24.96	21.84	38.88
Weight per pallet [kg]	590	510	480	490	320		310			520		550	520	550	510	520	510	530		370
Nominal thermal resistance R_D [m ² K/W]	0.50	1.00	1.50	2.00	2.50	3.50	3.00	4.00	2.00	2.50	3.00	2.00	2.50	3.00	2.00	2.50	3.00	3.50	4.00	1.50
sd value [m]	0.08	0.16	0.24	0.32	0.40	0.56	0.48	0.64	0.32	0.40	0.48	0.32	0.40	0.48	0.32	0.40	0.48	0.56	0.64	0.24

Product name	GUTEX Thermowall-gf						GUTEX Thermowall-L						GUTEX Thermowall Durio		
Bulk density ρ [kg/m ³]	~ 185						~ 110						~ 160		
Nominal thermal conductivity λ_D [W/mK]	0.043						0.038						0.040		
Vapour diffusion μ	3						3						4		
Compressive stress/strength [kPa]	≥ 150						≥ 50						≥ 100		
Tensile strength perpendicular to the surface [kPa]	≥ 20						≥ 7.5						≥ 10		
Short-term water absorption [kg/m ²]	≤ 1						≤ 1						≤ 1		
Air flow resistivity [kPa s/m ²]	≥ 100						≥ 100						≥ 100		
Specific heat capacity [J/kgK]	2100						2100						2100		
Maximum working temperature [°C]	110						110						110		
Fire reaction Euro Class as per EN 13501-1	E						E						E		
Joint type	Tongue and groove			Flush-mount			Flush-mount						Tongue and groove		
Thickness [mm]	40	60		40	60	40	60	120	140	160	180	200	70		
Length x width [mm x mm]	1300 x 600	1800 x 600	2576 x 1176	2600 x 1250	2800 x 1250	3000 x 1250	1250 x 590						1800 x 600		
Actual coverage: Length x width [mm x mm]	1275 x 575	1775 x 575	2551 x 1151										1780 x 580		
Actual coverage: Square metres per board [m ²]	0.73	1.02	2.94										1.03		
m ² /Piece(s)	0.78	1.08	3.02	3.25	3.50	3.75	0.73						1.08		
Weight per board [kg]	5.80	8.70	12.00	33.60	24.10	36.10	25.90	38.90	41.60	9.70	11.40	13.00	14.60	16.20	12.10
Weight per m ² [kg]	7.40	11.10		7.40	11.10	7.40	11.10	13.20	15.40	17.60	19.80	22.00	11.20		
Piece(s)/Pallet	108	72	36	18	24	15	24	15	36	32	28	24	22	32	
Square metres per pallet [m ²]	84.24	56.16	38.88	54.52	78.00	48.75	84.00	52.50	56.25	26.55	23.60	20.65	17.70	16.22	34.56
Weight per pallet [kg]	680	490	680	610	640	730	680	730	390						380
Nominal thermal resistance R_D [m ² K/W]	0.90	1.35		0.90	1.35	0.90	1.35	3.15	3.65	4.20	4.70	5.25	1.75		
sd value [m]	0.12	0.18		0.12	0.18	0.12	0.18	0.36	0.42	0.48	0.54	0.60	0.28		

Notes

The thermal resistivity is based on $\lambda_{90/90}$ and board thickness

GUTEX will be glad to send you test reports

GUTEX Multiplex-top and GUTEX Ultratherm: Guaranteed by Germany's Association of Roofers

GUTEX Standard-n: Other dimensions available by request

GUTEX Thermowall-gf: Suitable for REI 90 compliance-tested structures

GUTEX Pyroresist wall: Non-smouldering PB-Hoch-180895 as per EN 16733, Custom sizes are available

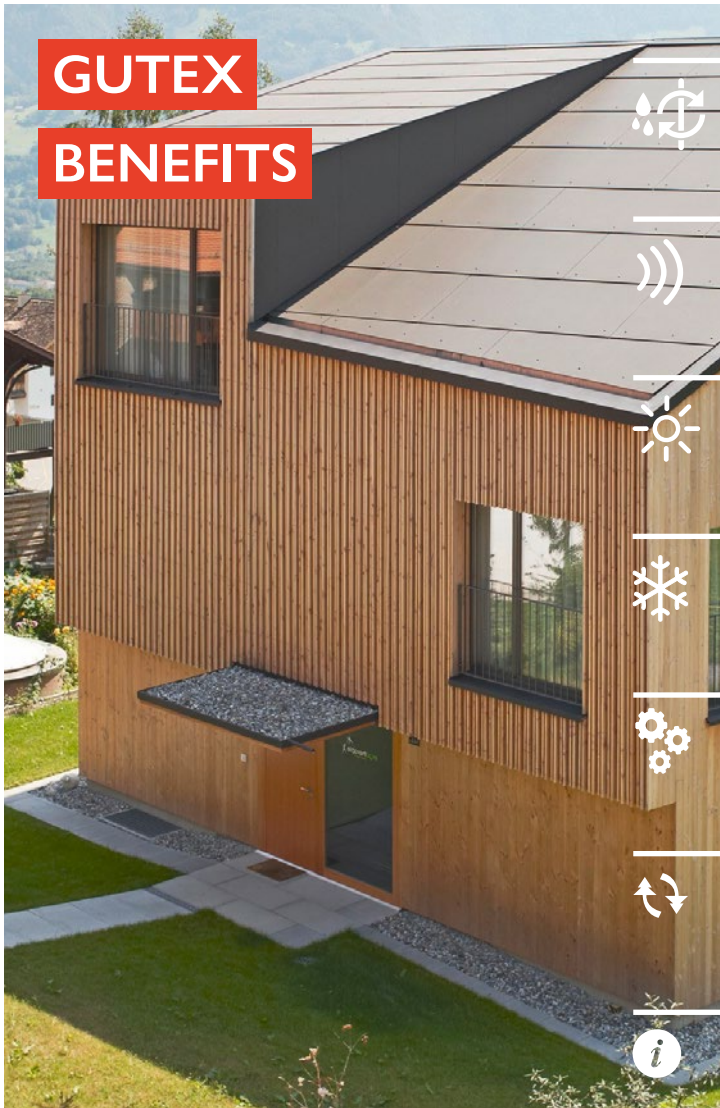

GUTEX
BENEFITS

Pleasant living climate



Perfect sound insulation



Summer heat protection



Winter cold insulation



System reliability



Sustainability



Service



Certified quality

Our products are made from sustainable Black Forest fir and spruce – the ideal basis for high quality wood fibre insulation materials. The natureplus® certificate also guarantees their health compatibility, environmentally friendly production, and suitability for use.



HOTLINE

GUTEX application engineering

+49 7741 6099-125 ▪ anwendungstechnik@gutex.de

